

PC4800 SERIES FUSING SYSTEMS

The PC4800 series fusing systems were designed to reflow multilayer or high mass circuit boards. The system consists of two independently controlled long wave IR emitting zones for a saturating preheat and one short wave IR emitting zone for a controlled reflow. The preheat zones total over 50" of conveyor providing ideal preheating.

The control system provides highly accurate temperature and lamp power control. Temperature control is within 2 degrees Celsius. Lamp power control is within 1% of full power. Conveyor speed is controlled to within 1% of full speed.

AVAILABLE OPTIONS

24" EXIT EXTENSION: Provides an additional 24" of exit conveyor on the exit of the fuser. This option is particularly useful for removing or visually inspecting parts prior to postcleaning.

CONVEYOR STOP ALARM: Provides an alarm and interlock system to disable all heat sources in the event of conveyor stoppage.

REMOTE CONTROL CONSOLE: Provides a separate NEMA rated console for the system controls a distance of up to 10 feet away from the machine.

CUSTOM CONVEYOR HEIGHT: Argus' standard equipment conveyor height is adjustable between 42-44 inches. Custom heights are available with this option.

ELECTRICAL SERVICE REQUIREMENTS

Circuit Breaker service is 3-phase configuration with a good Ground.

ITEM	200-208V 50/60HZ	220-240V 50/60HZ	380-415V 50HZ	440-480V 50/60HZ	POWER
PC4820 CIRCUIT BREAKER	150A	175A	100A	100A	48kVA
PC4830 CIRCUIT BREAKER	N/A	N/A	150A	150A	72kVA

Notes: PC4800 has a main exhaust blower that should be supplied separately for safety reasons. Blower will be supplied by Argus at the same supply voltage as the machine.

PC4800 has auxiliary blower for first preheat stage that is rated at 115V that should be supplied separately for safety reasons. Connection of this blower is optional.

EXHAUST SYSTEM REQUIREMENTS

MAIN EXHAUST

ITEM	VOLUME	TRANSITION ADAPTER	BLOWER POWER	DUCTING
PC4820	1500CFM	11.87" x 8.06" Rectangular to 10" Diameter	3/4HP	10" Galvanized
PC4830	2500CFM	13.25" x 9.75" Rectangular to 11.94" Diameter	1 1/2HP	12" Galvanized

AUXILIARY EXHAUST

ITEM	VOLUME	TRANSITION ADAPTER	DUCTING
PC4820	1000CFM	8.38" x 5.50" Rectangular to 8" Diameter	8" Galvanized
PC4830	1000CFM	8.38" x 5.50" Rectangular to 8" Diameter	8" Galvanized

Note: Transition and ducting to be supplied by user.

SHIPPING DATA

ITEM	CRATE SIZE	AIR FREIGHT CRATED WEIGHT	COMMON CARRIER CRATED WEIGHT
PC4820	123" x 63" x 65"	1,250 lbs.	1,700 lbs.
PC4830	123" x 63" x 65"	1,350 lbs	1,800 lbs.

Note: Crating dimensions and weights are approximate and may vary within 10%.

PC4800 SERIES FUSING SYSTEMS

PC4820 Physical Dimensions

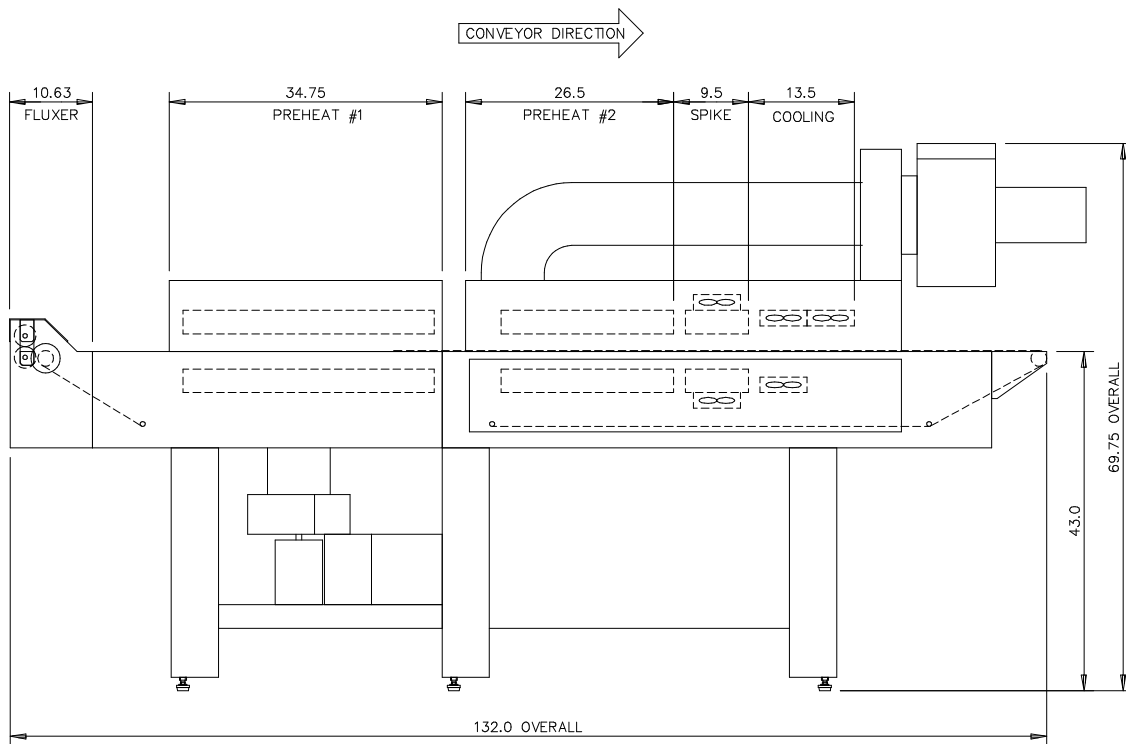
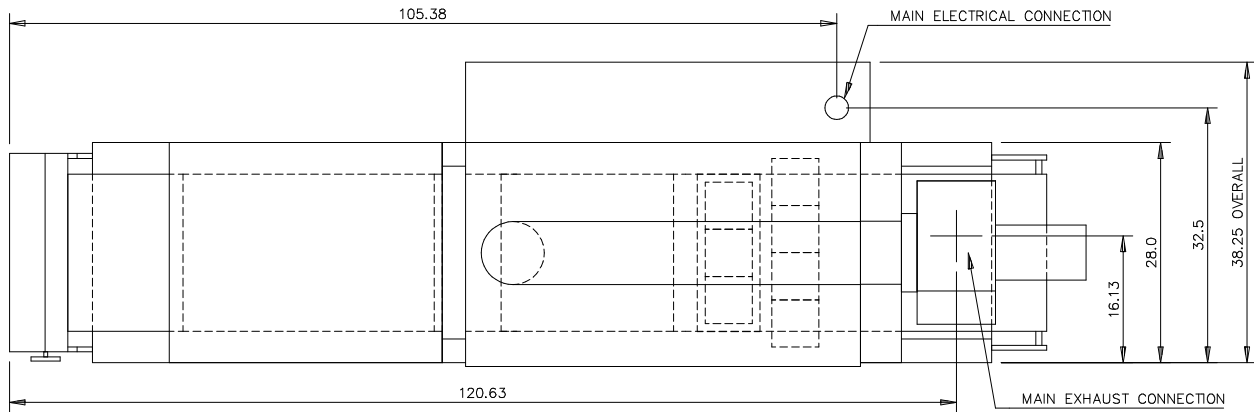

PC4800 SERIES FUSING SYSTEMS

PC4830 Physical Dimensions

